

oakheart

£190,000

Price Guide

Victoria Road, Chelmsford



**\*\*GUIDE PRICE £190,000 - £200,000\*\*** This well presented first-floor apartment boasts period-style charm. Offering generously proportioned rooms enhanced by impressive 9' high ceilings, this home creates a light and airy atmosphere throughout, making it an ideal retreat within the heart of the city.

The welcoming lounge is a standout feature, boasting a striking bay window that floods the space with natural light, while providing the perfect setting for both relaxation and entertaining. To the rear, the

kitchen comes fully fitted with integrated appliances, offering practical functionality for everyday living.

The double bedroom offers an inviting sanctuary, complete with excellent proportions and ample space for storage and furnishings. Complementing this is the bathroom which has been very well looked after and maintained by the current tenant.

Additional benefits include gas central heating and some double-glazed

windows, ensuring year-round comfort and efficiency. Outside, the property enjoys a private rear garden – a rare and desirable feature – offering a peaceful spot to unwind or entertain al fresco.

Positioned within walking distance of the vibrant city centre and mainline railway station, this apartment couldn't be better placed for both professionals and commuters. Early internal inspection is strongly advised to fully appreciate all that this impressive property has to offer.















No  
stopping  
Mon - Sat  
8am - 6pm  
on entrance  
markings





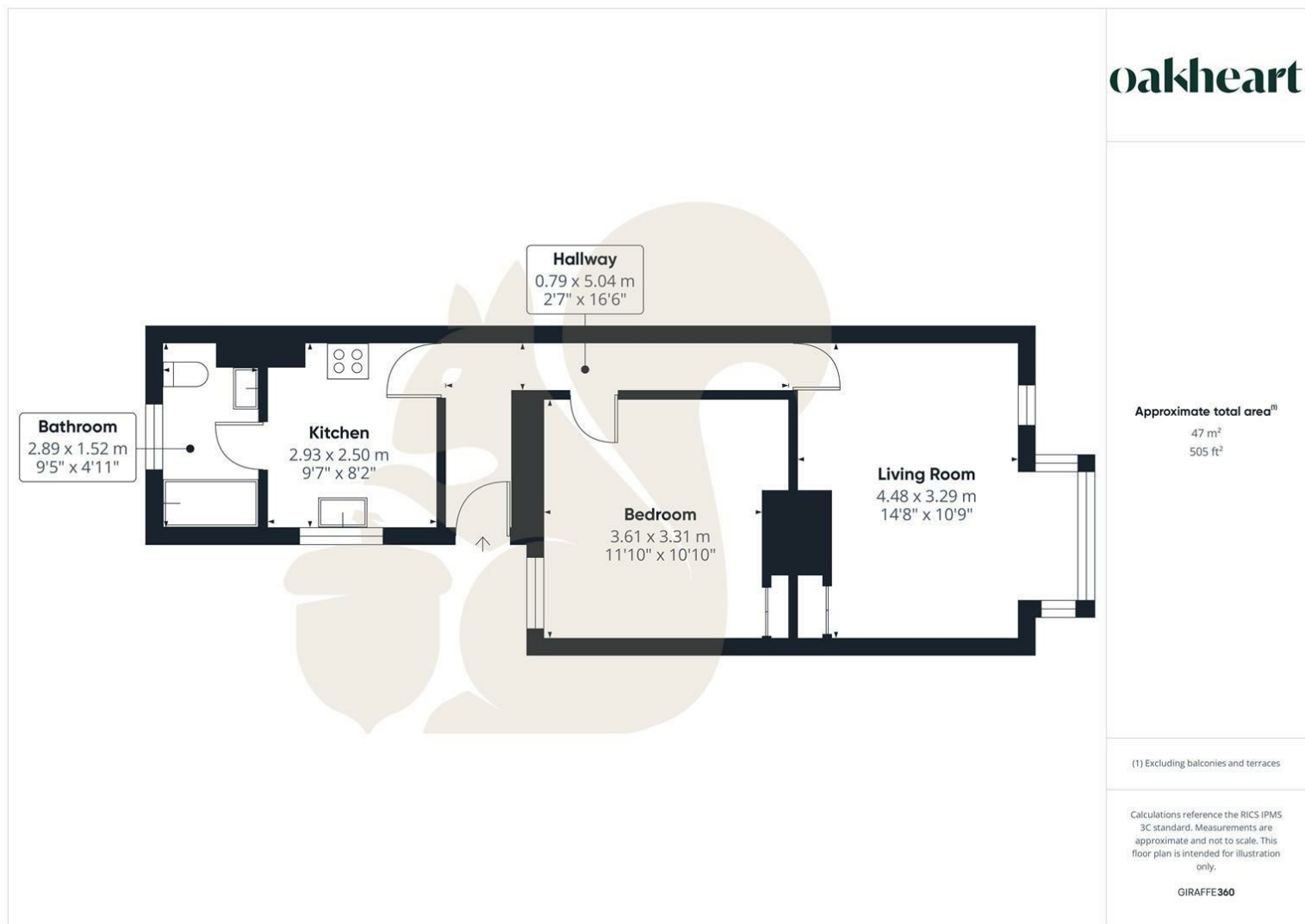

Local Authority:  
Chelmsford City Council

Tenure:  
Leasehold

Council Tax Band:  
A

### Energy Efficiency Rating

	Current	Potential
Very energy efficient - lower running costs		
(92 plus) <b>A</b>		
(81-91) <b>B</b>		
(69-80) <b>C</b>		
(55-68) <b>D</b>		
(39-54) <b>E</b>		
(21-38) <b>F</b>		
(1-20) <b>G</b>		
Not energy efficient - higher running costs		
<b>England &amp; Wales</b>	EU Directive 2002/91/EC	

Agents Note: Whilst every care has been taken to prepare these particulars, they are for guidance purposes only. All measurements are approximate and are for general guidance purposes only and whilst every care has been taken to ensure their accuracy, they should not be relied upon.

Oakheart Chelmsford  
01245 800181  
chelmsford@oakheart.co.uk  
20 Victoria Road, Chelmsford, Essex, CM1 1PA

**oakheart**